

SHEAR WALL SCHEDULE

- APA RATED SHEATHING - 60 COMMON OR GALVANIZED BOX NAIL @ 6" O.C. (PERIMETER) 12" O.C. (FIELD)
 - OR PERIMETER OF ALL PANELS MUST BE BLOCKED
 - OR 1/2" x 1 1/4" STAPLES @ 3" O.C. (PERIMETER) 6" O.C. (FIELD)
 - PERIMETER OF ALL PANELS MUST BE BLOCKED
1. SHEAR PANELS AT CORNERS TO BE NAILED PER IRC CODES. ALL SHEAR WALLS TO BE NAILED TO EDGE OF ANY CORNER, AND EVERY 12'-6" THEREAFTER
- TYPICAL SHEATHING NAIL PATTERN
- 6d NAILS @ 6" O.C. (PERIMETER) 12" O.C. (FIELD)
 - OR 16 GA. 3 1/4" STAPLES @ 3" O.C. (PERIMETER) 6" O.C. (FIELD)
 - UNLESS NOTED OTHERWISE
 - VERIFY IRC CODES IF ALTERNATE SHEAR PANELS ARE USED

WALL LEGEND



USE ADVANCED FRAMING TECHNIQUES, ENERGY CORNERS AND INSULATE ALL HEADERS

USE 1/2" GYP. BOARD BEHIND SHOWERS, TUBS AND FIREPLACES ON EXTERIOR WALLS, TYPICAL

ALL EXTERIOR WALLS TO HAVE CONTINUOUS SHEATHING OF 7/16" OSB

GENERAL NOTES

THE CONTRACTOR IS RESPONSIBLE TO VERIFY ALL INFORMATION SHOWN BEFORE BEGINNING WORK AND TO NOTIFY TUSH IMMEDIATELY IF ANY DISCREPANCIES ARE FOUND

ALL INFORMATION CONTAINED WITHIN THESE DRAWINGS AND ALL ENGINEERING CALCULATIONS ARE INTENDED TO MEET OR EXCEED 2009 IRC

ALL DESIGN CRITERIA NOT SHOWN ON THESE PLANS ARE TO CONFORM TO THE 2009 IRC

REV	DATE	DESCRIPTION

ADERA HOMES
HOME - SINGLE UNIT
FLOOR PLAN
LOT 17 / BLOCK 12 / SAIGUARO CANYON SUBDIVISION No. 2
IDAHO
MERIDIAN / ADA

AREA	SQ. FT.
BASE FLOOR	302
UPPER FLOOR	
BASEMENT	
TOTAL	3,219

CONC.	SQ. FT.
CONCRETE	
FORMWORK	
REINFORCEMENT	
AC PANELS	
UPPER FLOOR	
TOTAL	3,085

DATE	12/20/23
SCALE	AS SHOWN
DRAWN BY	JL
CHECKED BY	JL
DESIGNED BY	JL
CHECKED BY	JL
JOB NO.	240121

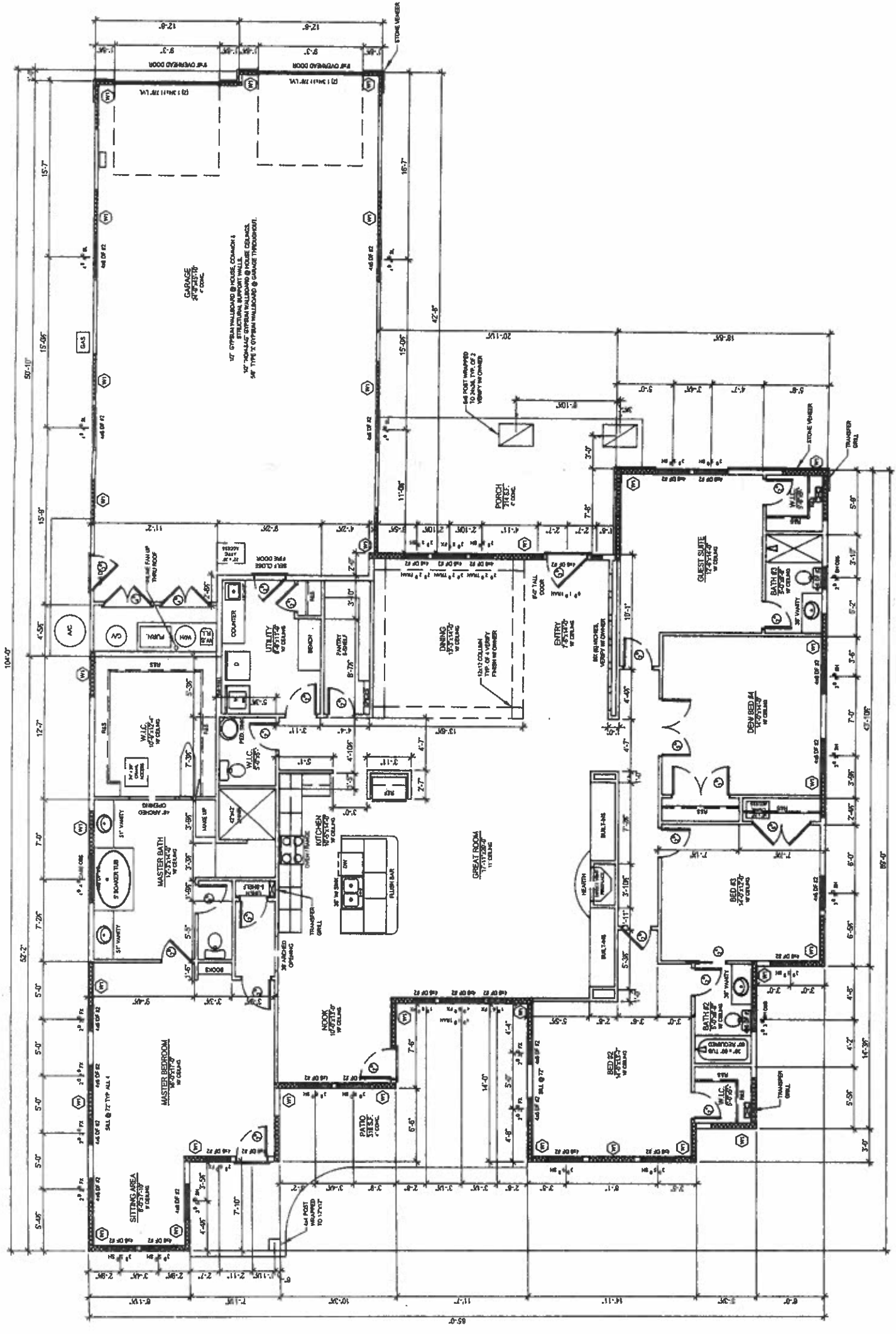

MAIN FLOOR PLAN

SCALE: 3/32" = 1'-0"